

CLICK ON THE COURSE TITLE FOR MORE DETAILS

Certification course on **BIM MANAGEMENT**

Date : 2 - 5 Sep 2019

PEB: 32 PDUs BOA-SIA: 4 CPD Points



GREEN MARK MANAGERS (GMM)

Date: 19 Sep – 11 Oct 2019

PEB: 27 PDUs BOA-SIA: 6 CPD Points

SPECIALIST DIPLOMA STACKABLE MODULAR CERTIFICATES



Specialist Diploma in Design for Manufacturing & Assembly

Modular Certificate B: Certificate in Management of Productive Technologies
Date: 30 Sep - Dec 2019

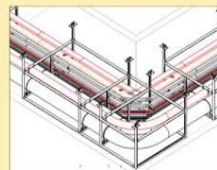

Specialist Diploma in MEP Modularisation

Modular Certificate B: Certificate in Digital Delivery of Modular MEP
Date: 30 Sep - Dec 2019



Specialist Diploma in Virtual Design and Construction

Modular Certificate B: Certificate in Virtual Design & Construction Process Management
Date: Oct - Dec 2019



CONSTRUCTION & SAFETY

Mobile Crane Operation
Date: 11 to 27 Sep 2019

Hydraulic Excavator Operation*
Date: 12 to 28 Sep (Day)
Date: 18 Sep to 29 Oct (Evening)

Demolition Course for Renovation Contractors
Date: 6 Sep 2019

Apply Workplace Safety and Health in Construction Sites*
Date: Sep 2019 Intake

Supervise Construction Work for WSH*
Date: Sep 2019 Intake

Managing Noise in Construction Sites
Date: 11 Sep 2019
PEB: 7 PDUs IES-ACES: 2 STU (Safety)
WSH-CPD: 8 SDUs

Workshop to Enhance Safety of Crane Operations
Date: 12 Sep 2019 / 3 Oct 2019

Behavioural Safety for the Construction Industry
Date: 10 & 11 Oct 2019
PEB: 14 PDUs WSH-CPD: 14 SDUs IES/ACES

*SDF funding is available for company-sponsored Singaporeans and Singapore PRs (T&C apply)

SHORT COURSES



Essential Knowledge in Construction Regulations for Licensed Builders - English

Date: 9 - 11 Sep 2019



Certificate in Concrete Technology

Date: 23 -24 Sep 2019

PEB: 11 PDUs IES-ACES: 12 STU (Structural)



Maintenance of Electrical Equipment for FM Personnel

Date: 27 Sep 2019

PEB: 6 PDUs



QUALITY

Good Industry Practices (Painting)

Date: 17 Sep 2019

BOA-SIA: 4 CPD Points