

CLICK ON THE COURSE TITLE FOR MORE DETAILS

BUILD UP YOUR CAPABILITY

Up to **90%** WTU Funding is available (T&C Apply)

Stackable Modular Certificates SPECIALIST DIPLOMA PROGRAMMES



Flexible



Bite-sized



100% Continual Assessment



Specialist Diploma in **Design for Manufacturing & Assembly**

Modular Certificate B: Certificate in Management of Productive Technologies

Date: 2 Oct - Dec 2019

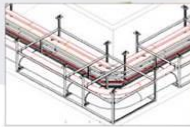

Specialist Diploma in **MEP Modularisation**

Modular Certificate B: Certificate in Digital Delivery of Modular MEP

Date: 30 Sep - Dec 2019



Specialist Diploma in **Virtual Design & Construction**

Modular Certificate B: Certificate in Virtual Design & Construction Process Management

Date: 30 Sep - Dec 2019

Green Mark for Super Low Energy Buildings – Active and Passive Strategies

Date: 22 & 23 Oct 2019

PEB: 12 PDUs | BOA-SIA: 3 CPD Points | SGBC-GMAP CPD Points: 6

SHORT COURSES



Way-finding and Signage Design

Date: 19 September 2019

BOA-SIA: 2 CPD Points | SILA: 2 CPD Points



BIM Modelling (MEP)

Date: 10, 11, 14 & 15 October 2019

BIM Modelling (Architecture)

Date: 22 - 25 October 2019



Construction Contract Procurement & Negotiations

Date: 16 & 17 October 2019

PEB | BOA-SIA | SISV



Design of Steel-Concrete Composite Structures using Eurocode 4

Date: 30 & 31 October 2019

PEB | IES-ACES



Good Industry Practices - Timber Doors, Wardrobe & Kitchen Cabinet

Date: 8 October 2019

BOA-SIA

CONSTRUCTION & SAFETY

Crawler Crane Operation*

Date: 1 to 17 Oct 2019

Mobile Crane Operation*

Date: 11 to 27 Sep 2019

Hydraulic Excavator Operation*

Date: 12 to 26 Sep (Day)

PPVC Lifting Course for Crane Operators*

Date: 6 Sep 2019 / 9 Sep 2019

Behavioural Safety for the Construction Industry

Date: 10 & 11 Oct 2019

PEB: 14 PDUs | WSH-CPD: 14 SDUs | IES-ACES

Apply Workplace Safety and Health in Construction Sites*

Date: Sep 2019 Intake

Supervise Construction Work for WSH*

Date: Sep 2019 Intake

Managing Noise in Construction Sites*

Date: 11 Sep 2019

PEB: 7 PDUs | IES-ACES: 2 STU Points | WSH-CPD: 8 SDUs

Workshop to Enhance Safety of Crane Operations

Date: 12 Sep 2019 / 3 Oct 2019 / 10 Oct 2019

*SDF funding is available for company-sponsored Singaporeans and Singapore PRs (T&C apply)